

# VERSAMAX<sup>TM</sup>

SOLID PHENOLIC LOCKERS

AMERICA'S MOST COMPLETE LOCKER LINE<sup>®</sup>

**SUPERIOR<sup>®</sup>**  
LOCKERS



Proudly Made in America  
Since 1936

**LIST INDUSTRIES INC.**

## **VERSAMAX™ SOLID PHENOLIC LOCKERS**

### **Superior® Lockers for Superior® Satisfaction**

VersaMax™ Solid Phenolic lockers are engineered to the same high level of integrity found throughout our Superior® locker line.

The unique qualities of phenolic resin offer many value added benefits:

- ✓ **Environmentally smart**
- ✓ **Moisture resistant, perfect for wet or damp areas**
- ✓ **Mold and mildew resistant**
- ✓ **Many color and finish options**
- ✓ **Laminate surface is graffiti and scratch resistant**
- ✓ **Standard Phenolic material is Class 2, Class B Fire Rated**  
**ASTM E84 Class 1, Class A Fire Rated is available as an upgrade**



## **Superior® Styles for Superior® Space Management**

VersaMax™ Solid Phenolic lockers are available in a variety of locker styles to meet your specific storage needs.



**Single Tier**



**Double Tier**



**Triple Tier**



**Four Tier**

- **Single Tier** lockers are perfect for hanging of longer garments
- **Double Tier** lockers offer plenty of height for hanging coats and garments while using half the floor space of a single tier locker
- **Triple Tier** lockers are our most economical wardrobe locker allowing hanging garments to be draped from the coat hook
- **Four Tier** lockers provide ample storage for larger personal items like backpacks, totes, etc.



**Five Tier**



**Six Tier**

- **Five tier** lockers are available in 12" and 14.4" high openings allowing for storage of personal belongings
- **Six Tier** lockers are the most economical storage solution for purses, bags, phones and other smaller personal items



**Z-Style**



- **Z-Style Lockers** are the perfect compromise between single and double tier lockers offering the perfect solution when space is at a premium, but hanging of longer garments is needed.



# VERSAMAX™ SOLID PHENOLIC LOCKERS



## STOCK PHENOLIC LOCKER SIZES

Tier	Width	Depth	Opening Height	Overall Height
Single Tier	12"	18"	72"	72"
Double Tier	12"	18"	36"	72"
Six Tier	12"	18"	12"	72"
Z-Tier	12"	18"	42"	72"

Available from stock with three locking options:  
Padlock Hasp, Key cam lock, Digitech electronic locks.

## PRODUCTION PHENOLIC LOCKER SIZES

Tier	Width	Depth	Opening Height	Overall Height
Single Tier	9", 12", 15", 18", 24"	12", 15", 18", 20", 24"	36", 48", 60", 72"	36", 48", 60", 72"
Double Tier	9", 12", 15", 18", 24"	12", 15", 18", 20"	18", 24", 30", 36"	36", 48", 60", 72"
Triple Tier	9", 12", 15", 18"	12", 15", 18", 20"	12", 20", 24"	36", 60", 72"
Four Tier	9", 12", 15", 18"	12", 15", 18", 20"	12", 15", 18"	48", 60", 72"
Five Tier	9", 12", 15", 18"	12", 15", 18", 20"	12", 14.4"	60", 72"
Six Tier	9", 12", 15", 18"	12", 15", 18", 20"	12"	72"
Z-Style	12", 15", 18"	12", 15", 18", 20"	36/24", 42"/30"	60", 72"
Sport	18", 24" 30", 36"	18", 20", 24"	N/A	72", 84"

# VERSAMAX™ SOLID PHENOLIC LOCKERS

## Superior® Construction for Superior® Durability

### DOORS:

#### Our door over body design provides several major benefits

- Allows air-flow from all directions for maximum locker ventilation without unsightly door perforations
- Provides an added 2-3" of clear locker opening which can provide up to 25% more storage space vs conventional door in frame lockers
- Esthetically pleasing modern design with clean shadow lines and reveals
- Doors are 1/2" thick solid phenolic

### BODY:

#### Construction of our locker body is second to none

- Interlocking components by means of dado and mortise & tenon joints reinforced with stainless steel screws for perfect alignment and maximum strength
- Top, bottoms and shelves are 3/8" thick solid phenolic
- Sides are 5/16" thick solid phenolic
- Backs are 5/16" thick solid phenolic

### HARDWARE AND ACCESSORIES:

#### We utilize the industry's best available hardware to meet the high expectations of our customers.

- **Door Hinges** are 14 gauge 5-knuckle 304 stainless steel with eased top and bottom edges for safety allow doors to open a full 180-degrees.
- **Hinges** are powder coated black to match phenolic core
- **Padlock Hasp** is fabricated from 11 gauge 304 stainless steel
- **Hanging garment J-Hooks** are 304 stainless steel
- **Door Pull** is 304 Stainless Steel and powder coated black to match phenolic core
- **Number Plates** are aluminum and included at no additional charge. They are etched with numbers 1 and up unless otherwise specified. Doors are pre-drilled to allow for easy installation of number plates
- **Assembly Hardware:** Stainless Steel tamper resistant torx head through-bolts are used for locker component assembly and hardware installation

### VARIOUS LOCKING OPTIONS:



Padlock Hasp



DigiTech™ Electronic Locks



Built-In Key Cam Locks



DigiTech™ RFID  
Electronic Locks



Built-In Combination Locks

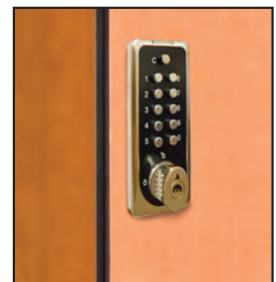

Mechanical Shared Use  
Locks



Coin or Token Locks



# VERSAMAX™ SOLID PHENOLIC LOCKERS

## Superior® Design for Superior® Performance

### STANDARD FEATURES

- ✓ 3/8" Panel Construction with 1/4" Back
- ✓ Shoulder Pad Storage Area
- ✓ Security Box with 1/2" thick door
- ✓ Standard with padlock hasp
- ✓ Open Shelf Area
- ✓ Chrome Coat Rod
- ✓ Clothing Hooks
- ✓ Ventilated Foot Locker With Seat

### Available Sizes

Widths: 18", 24", 30", 36"

Depths: 18", 20", 24"

Heights: 72", 84"



*Shown with  
optional DigiTech  
Electronic Lock*

### OPTIONAL FEATURES



Shoulder Pad Rack



Shoulder Pad & Helmet Rack

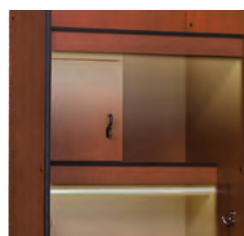

LED Lighting Kits

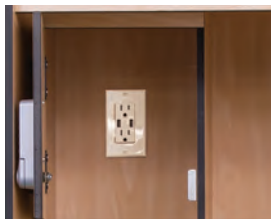

Optional USB & 110w Power Outlet  
in rear of security box



Name Plate Holders

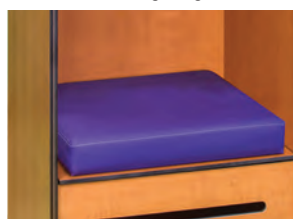

Seat Cushion



Foot Locker Ventilation Kit  
Two 110w fans move air thru foot locker

# VERSAMAX™ SOLID PHENOLIC LOCKERS



## Benches & Pedestals

Locker Benches are 9-1/2" wide x 3/4" thick. Bench tops are standard in one foot increments from 3' thru 12'. Non-standard lengths are available on special order (pedestal requirement will be for next standard size up).

BENCH TOP LENGTH	3' - 5'	6' - 8'	9' - 12'
PEDESTALS REQUIRED	2	3	4

Pedestal spacing not to exceed 40" O.C.



SHOWN WITH 4810  
PEDESTALS



### 4805 Heavy Duty Steel Pedestal

fabricated from 14 gauge  
steel tube with 11 gauge  
formed flanges  
Color: Parchment



### 8032 Adjustable Steel Pedestal

with cast aluminum  
base and concealed  
anchoring to floor  
Color: Parchment



### 4810 EXTRA Heavy-Duty Cast Iron Pedestal

with 6" diameter top and  
bottom flanges  
Color: Parchment



### 4820 Aluminum Movable Pedestal

includes holes for optional  
permanent anchoring to floor  
Color: Parchment



### 4825 Stainless Steel Movable Pedestal

fabricated from 16 gauge  
stainless steel. Designed for  
movable and fixed use  
Color: Unpainted



VersaMax™ lockers use Wilsonart® engineered surfaces, a world leading manufacturer of phenolic products.

## **18 DESIGNER COLORS**



Colors shown are an approximate representation of the actual color. Please do not make your final color selection from printed media or Internet images, as they may not be 100% accurate. For a more accurate color selection call 800-776-1342 or e-mail us at [info@ListIndustries.com](mailto:info@ListIndustries.com) to request actual color samples.



**LISTINDUSTRIES.COM**

**1-800-776-1342**

**401 JIM MORAN BLVD., DEERFIELD BEACH, FL 33442**

